

SUMNER stone veneer fixed with
SUMNER Grip adhesive to 9mm
SUMNER Board after first coating with
SUMNER Prime.

SUMNER L Fixings at 600mm
Vertical and Horizontal centers

SUMNER 45x18mm Battens over
Frame Protection System complying
with NZBC

BGC UPVC punched cavity closer

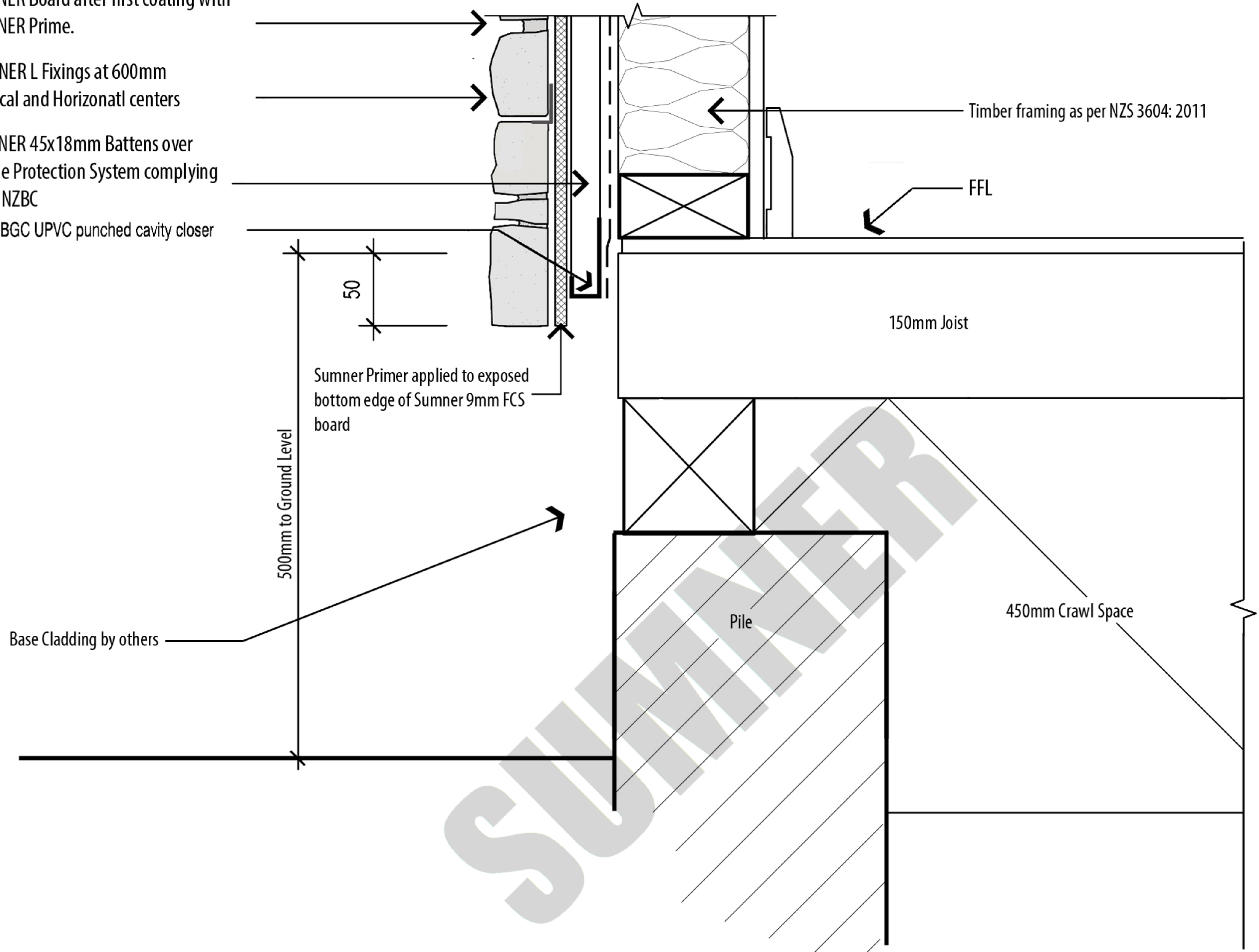

2.1

Sumner Vertical X-Section Through Timber Floor Foundation

SCALE

NTS

DATE

October 14



Original Stone Co Ltd
PO Box 125 029, St Heliers
Auckland 0800 157 340