

7.0

SUMNER Masonry Slab Edge Detail
(Block, Tilt Slab, Solid Pour Concrete Construction)

SCALE	NTS	DATE March 2014
		Original Stone Co Ltd PO Box 125 029, St Heliers Auckland 0800 157 340

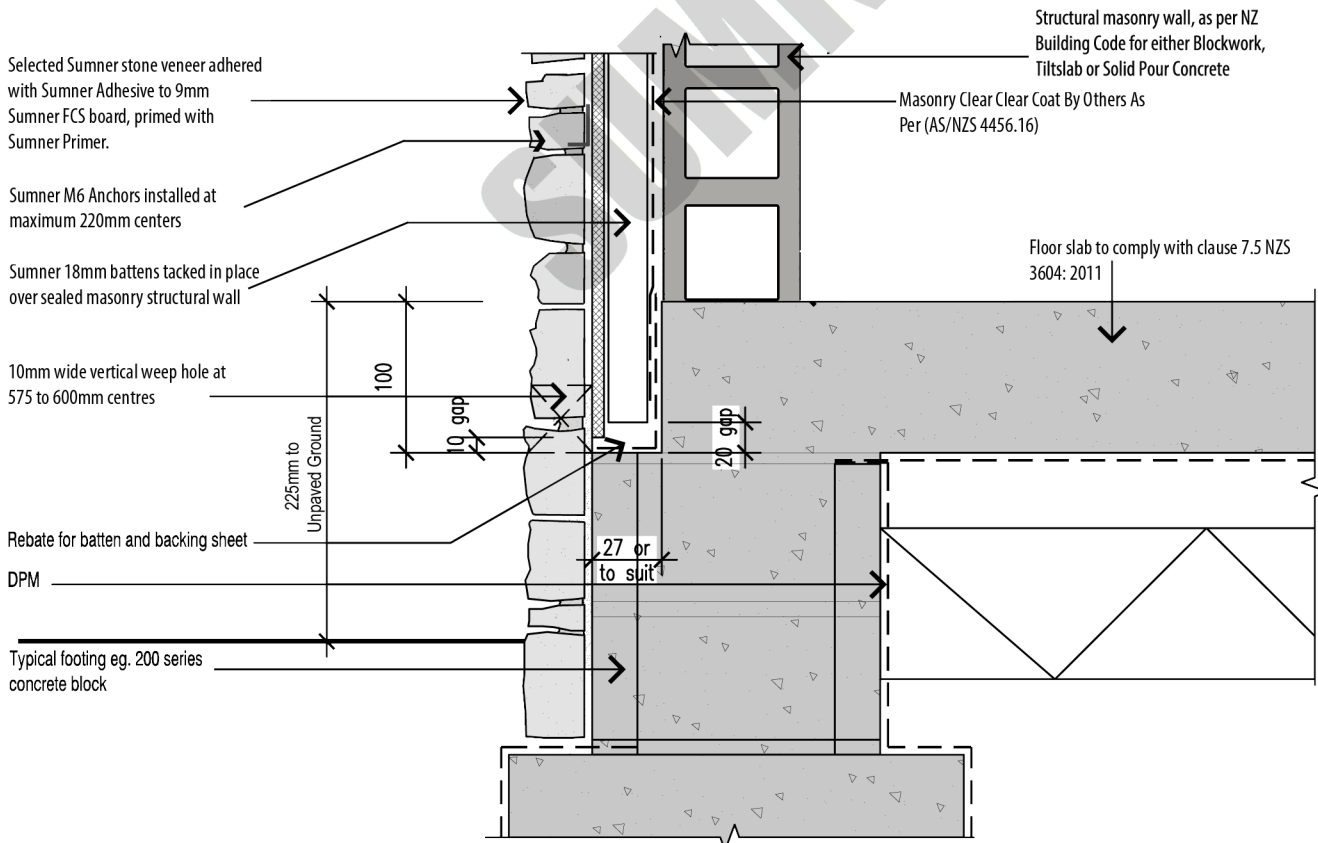

7.1

SUMNER Rebated Masonry Slab Edge Detail
(Block, Tilt Slab, Solid Pour Concrete Construction)

SCALE	NTS	DATE March 2014
		Original Stone Co Ltd PO Box 125 029, St Heliers Auckland 0800 157 340