

SUMNER approved stone veneer fully adhered using SUMNER Grip to 9mm SUMNER Board after first coating with SUMNER Primer.

SUMNER VERMINI Battens 45x18mm over Frame Protection System complying with NZBC

SUMNER L Fixings at 600mm Vertical and Horizontal centres

X - Refer to Table 7

Turn down to suit roofing profile

Frame Protection System over apron flashing upstand

Hem to flashing edge by others

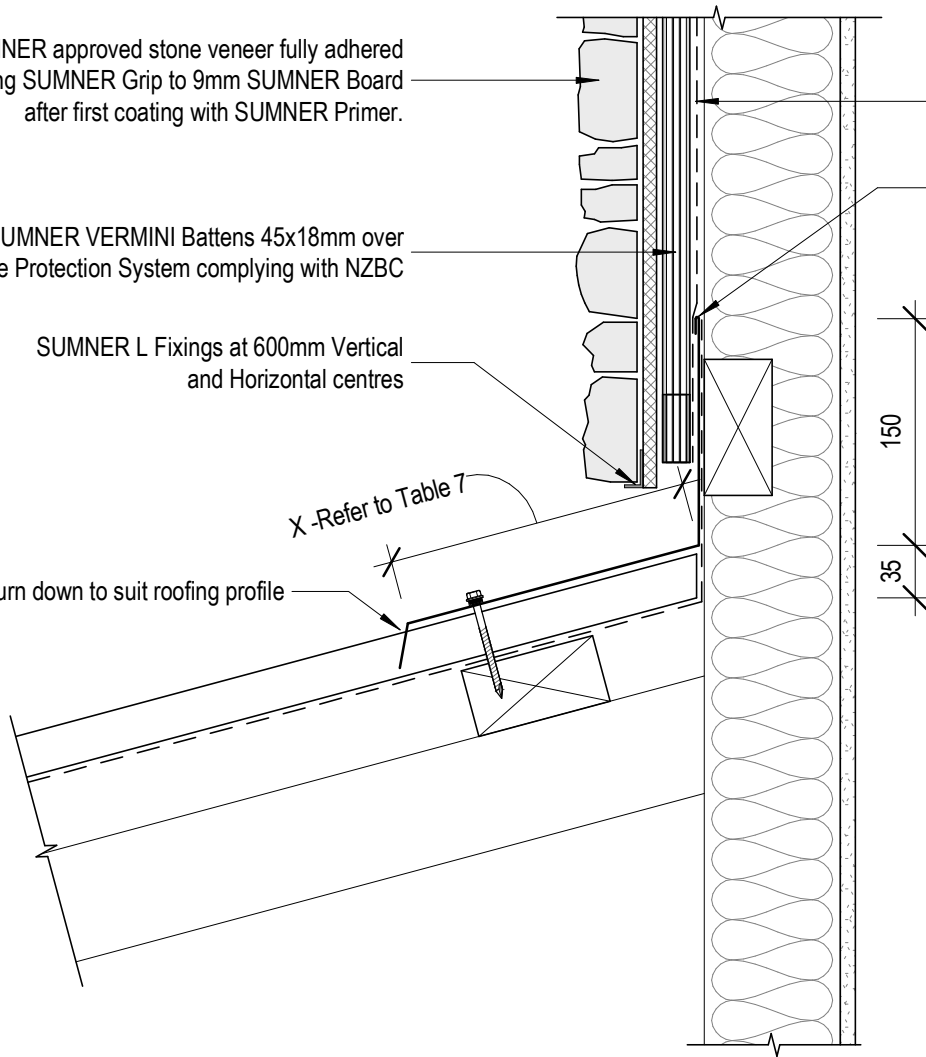

**CODEMARK™**  
BCS-171817-CMNZ



**SUMNER**  
PROFESSIONAL CLADDING SYSTEMS

[www.sumnerschist.co.nz/](http://www.sumnerschist.co.nz/)

## Approved Stone Veneer on SUMNER Tile System

### Roof Detail - Apron Flashing

Date April 2019

Drawn by SUMNER

Checked by DS

**3.4.2**

Scale 1 : 5