

Metal cap, 10° pitch, side fix only with pre-finished tech head screw class 3.

H3.1 timber blocking to suit

DYNAFLASH 50mm by others

Offset vertical screws to avoid interaction with horizontal screws

SUMNER VERMINI Battens 45x18mm over Frame Protection System complying with NZBC

SUMNER approved stone veneer fully adhered using SUMNER Grip to 9mm SUMNER Board after first coating with SUMNER Primer.

SUMNER L Fixings at 600mm Vertical and Horizontal centres

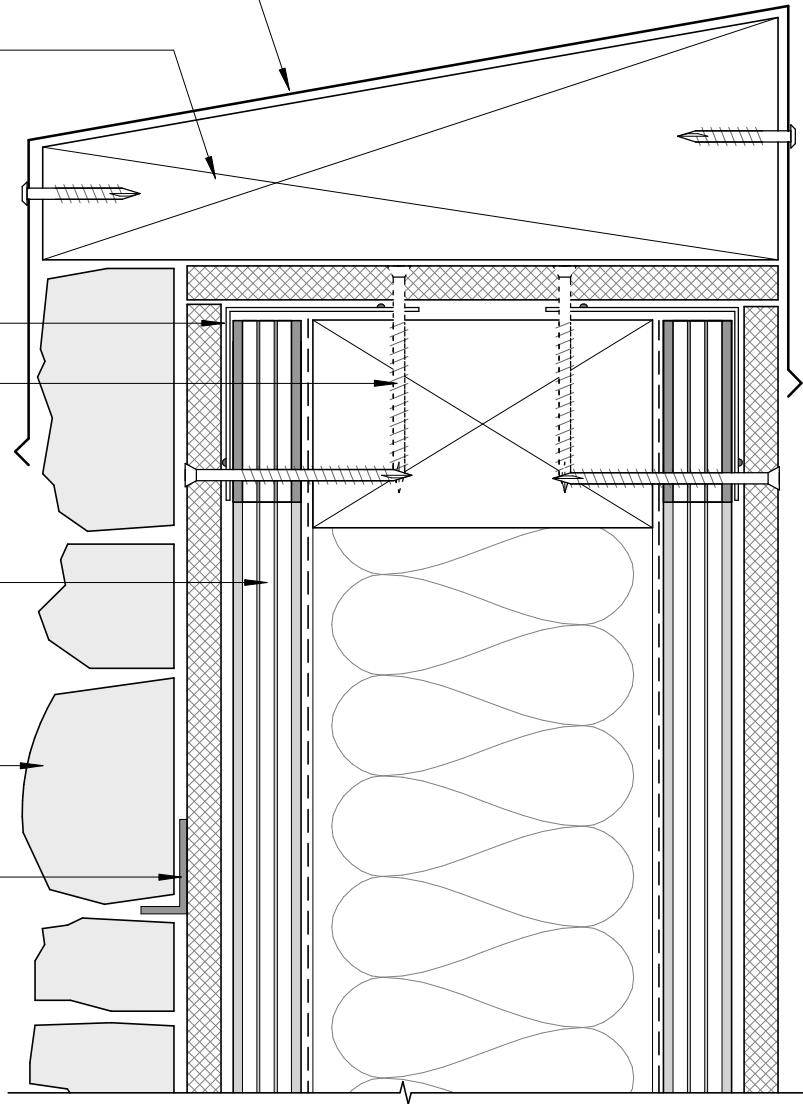

**CODEMARK**<sup>TM</sup>  
BCS-171817-CMNZ



**SUMNER**  
PROFESSIONAL CLADDING SYSTEMS

[www.sumnerschist.co.nz/](http://www.sumnerschist.co.nz/)

Approved  
Stone Veneer  
on SUMNER  
Tile System

Parapet

Date April 2019

Drawn by SUMNER

Checked by DS

**9.0.0**

Scale 1 : 2